

# MODEL ADE & ADR ACCESS DOORS

STANDARD INDUSTRY TOLERANCES APPLY. SPECIFICATIONS SUBJECT TO CHANGE WITHOUT NOTICE.

## STANDARD CONSTRUCTION

### FRAME

22 gage (.8) galvanized steel with seal.

### DOOR

24 gage (.7) galvanized steel.

### MODEL

ADR1 – Removable, single skin.

ADE1 – Hinged, single skin.

ADR2 – Removable, double skin.

ADE2 – Hinged, double skin.

### HINGE (ADE Models Only)

Continuous piano type.

### LOCKS

ADH Models – Doors 16" (406) and under have one lock, doors over 16" (406) have two locks.

ADC Models – Doors 16" (406) and under have two locks, doors over 16" (406) have four locks.

### SEALS

Foam gasket.

### INSULATION

1" (25) fiberglass.

### MINIMUM SIZE

6"w x 6"h (152 x 152).

### MAXIMUM SIZE

24"w x 24"h (610 x 610).

### INSTALLATION

Cut hole 1 1/8" (28) smaller than door size.

### NOTES

1. Dimensions shown in parenthesis ( ) indicate millimeters.
2. Access doors furnished actual size.

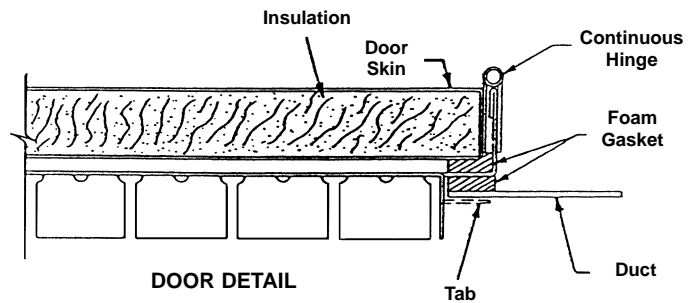
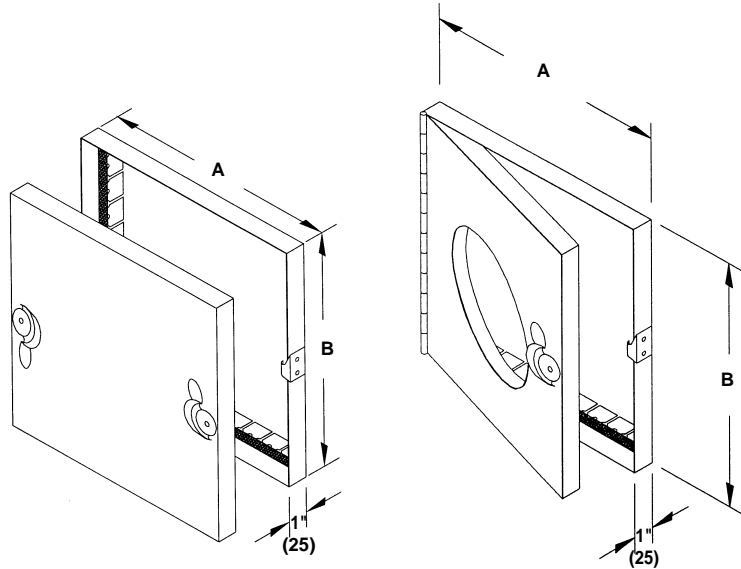

PROJECT: \_\_\_\_\_

ARCHITECT: \_\_\_\_\_

ENGINEER: \_\_\_\_\_

CONTRACTOR: \_\_\_\_\_

LOCATION: \_\_\_\_\_



**J&J REGISTER**  
AIR DISTRIBUTION PRODUCTS